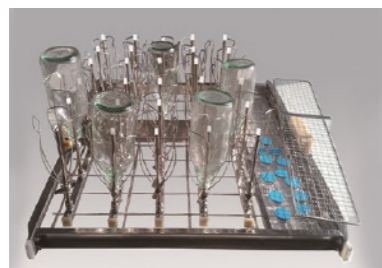
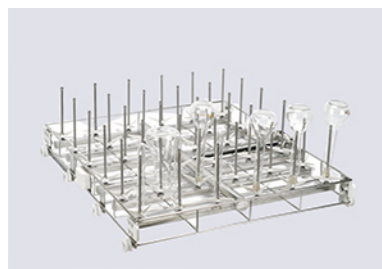

INIR30

30 nos. of dropping bottle + basket for caps

INIR36

36 nos. of 250ml erlenmeyer flasks, volumetric flasks, beakers, test tube, etc.
(distance between injectors 99*90mm)

INIR38

38 nos. of cylinder. To simultaneously wash measure cylinder 16 nos. of 5~25ml, 12 nos. of 50~250ml, 6 nos. of 500ml and 4 nos. of 1000~2000ml

INIR60

60 nos. of erlenmeyer flasks, volumetric flasks, beakers, test tube, etc.
(distance between injectors 72*70mm)

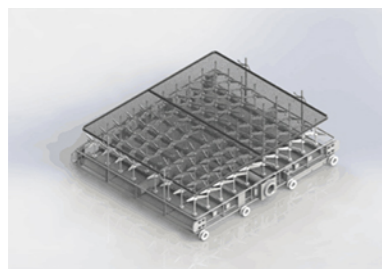
INIR80

80 nos. of small beaker rack. To wash small beakers, centrifuge tubes, volumetric flasks, etc.
(distance 56mm)

INIR11218

112 nos. of injector for beakers, erlenmeyer flasks, volumetric flasks etc.(distance between injectors 30*30mm)+18 nos. of injector for beakers, erlenmeyer flasks, volumetric flasks etc.
(distance between injectors 90*86mm)

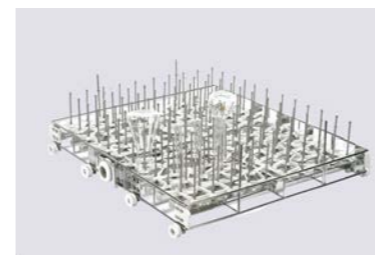
INIR120

120 nos. injectors. To wash 120 nos. of test tubes, 120 nos. of less than 50ml volumetric flasks, etc. (distance between injectors 53*48.5mm)

INIR222

222 nos. injectors, 222 nos. of autosamper vials, test tubes (distance between injectors 31*23mm)+1 set of basic basket (bottle caps, stoppers etc.)

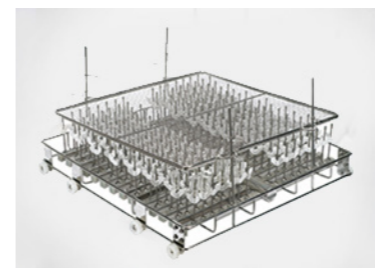
INIR260

260 nos. of autosamper vials, test tubes
(distance between injectors 38*23mm)

INAB40

To wash 40 nos. of different specification of absorbin bottle and sample bottle

INRTR20

To wash 20 nos. of rubber tube with its inner diameters 3~8mm and length less than 3m

INPR60

60 pieces of pipette. To wash 60 nos. of 550mm pipettes/straws. It can also wash some wide mouth glassware such as beaker

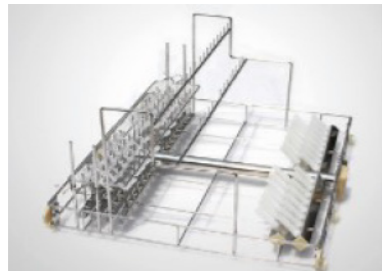
INPR6060

60 nos. of pipette and 60 nos. of autosamper vials

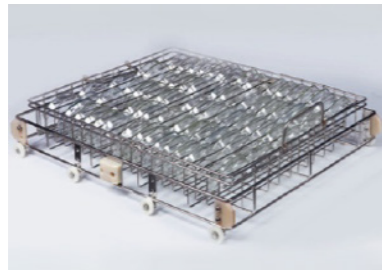
INPDR9070U

70 nos. of culture dishes within diameters 90mm (upper layer)

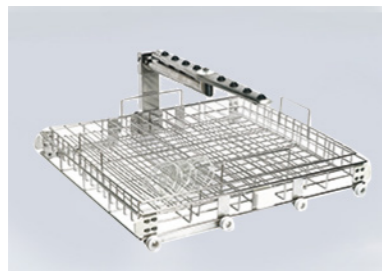
INPDR9070L

70 nos. of culture dishes within diameters 90mm (lower layer)

INMR04/INMR05

Medical device rack. 4 or 5 layers, 2 baskets per layer

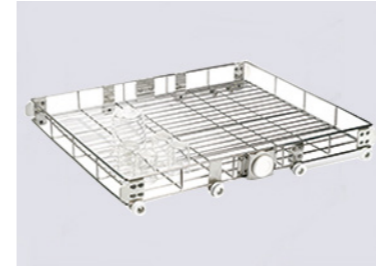
INBR01

Without injectors, to wash wide mouth flasks such as beaker, the area is 596mmx513mm.

